



# East Worlington Parish Hall Newsletter



Edition No 34 [www.eastworlingtonparishhall.btck.co.uk](http://www.eastworlingtonparishhall.btck.co.uk) 12 February 2016

## Parish Hall Conservation and Improvement Project

Edition 17 - Week Ending 12 February 2016

### This Week's Focus

Progress is made with the thatching of the rear side of the roof. Internally the installation of supporting timbers is completed, and work is started on lining the roof ready for plastering.

### Thatcher starts to lay the top layer of thatch

This week the thatcher has started laying the top layer of thatch. Starting on the right hand side of the roof he is working to the left and building layer on layer up the roof.



### Joiner completes work on supporting A-frames

The A-frames are supported across the span of the Hall by additional cross-members. These have been installed by the project joiner. New timber has only been installed where necessary and existing timber have been retained and show the character and history of the building.



Supported by

**The National Lottery®**  
through the Heritage Lottery Fund



# Parish Hall Conservation and Improvement Project

## Thatching spars

There was concern that the thatching spars might protrude into the roof space and maybe puncture through the plasterboard. Currently this has not been a problem. It is possible just to see in the photographs a spar protruding below the thatch but it does not reach the plasterboard line.



## Lining the roof

The roof is being lined by plasterboard. This is required on this project to provide a fire check and for economic reasons.

Between the thatch and plasterboard is a layer of insulation.

The work of installing the plasterboard is precise and each piece has to be cut to fit round the shapes of the timbers.



## The stage

The construction of the stage has been commissioned. The Carpenters and Joiners undertaking the work are G S Haydon and Son.

This is a detail drawing produced by our Project Manager, Richard Boxall, a Chartered Building Surveyor. It shows the contractor the layout of the stage position.

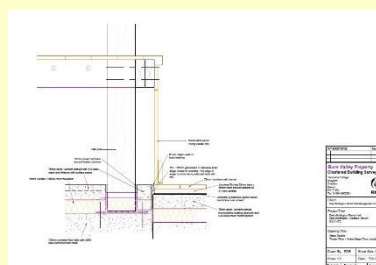

## Key details:

For **bookings** please contact: **Lorna Manton**

**Tel:** 01884 860657

**Email:** [bookings@ewph.uk](mailto:bookings@ewph.uk)

Please contact us to discuss your particular requirements

